

LUAS

Sandyford to Cherrywood (Line B1)

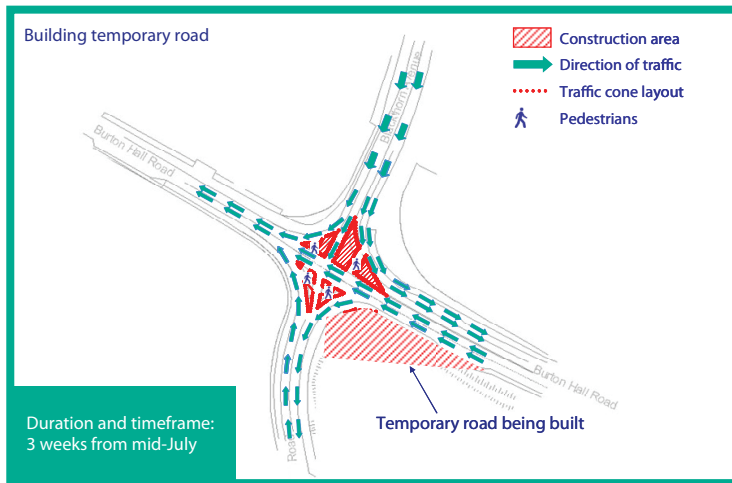
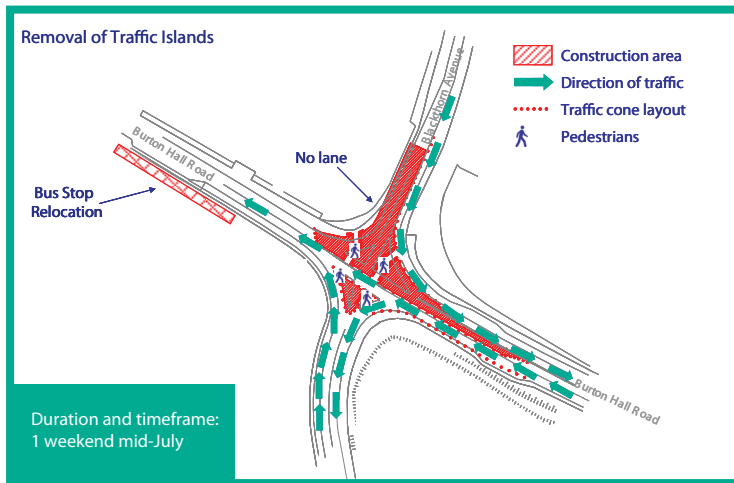

TRACK AND CIVIL WORKS

The main infrastructure contractor, Somague Bowen Sacyr JV (SBS), will continue work in the depot at Sandyford during July in preparation for the laying of new tracks to accommodate the expanded Green Line fleet.

Sandyford Stop

Upgrading of Sandyford Stop commenced in June. During July work on the outbound platform is expected to begin and a new temporary ticketing area will be provided. To facilitate passengers the Ticket Machines and Luas SmartCard Validator will be moved to an area in front of the stop. The route through the stop will change from time to time; for your comfort and safety please follow the directional signs provided.

Burton Hall Road Junction

Work will commence in July on laying track across the Burton Hall Road Junction following the completion of the local Council's waterworks upgrade. The track installation at this junction is expected to take approximately 10 weeks. Preliminary works will commence during July, and will include the relocation of the Bus Éireann and Airccoach bus stops and the building of a temporary road at the southern end of the junction.

From late July, Heavy Goods Vehicles (HGV) movement will be restricted along Blackthorn Avenue for a period of approximately seven weeks. HGVs will not be able to turn left from Blackthorn Avenue onto Burton Hall Road during this time. However, they will still be able to turn right. HGV drivers are requested to follow all HGV diversion signs on all approaches to Blackthorn Avenue and along Blackthorn Avenue and Burton Hall Road.

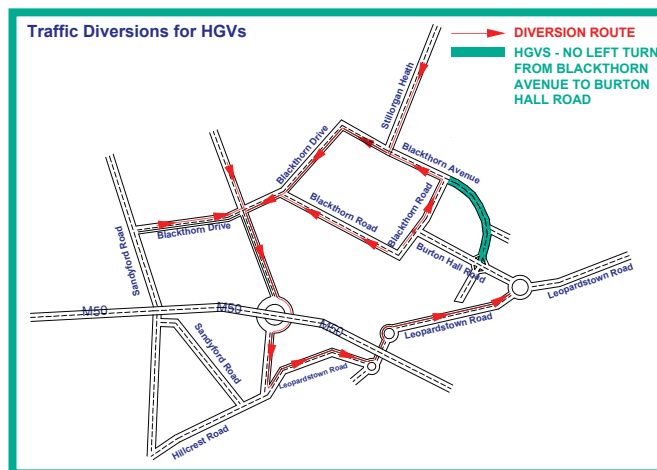

Otherwise, normal traffic flow will be maintained at the junction during July with the exception of one weekend during which traffic flow will be reduced to a single lane to facilitate the removal of the existing traffic islands. Drivers, cyclists and pedestrians are requested to follow all diversion signs on all approaches to the junction. (Please see maps above)

Luas Services - Late Saturday & Sunday Starts at Sandyford, Stillorgan & Kilmacud Luas Stops

To facilitate the on-going construction of the Luas Green Line extension Sandyford, Stillorgan and Kilmacud Stops will be closed until 9.15am on Jul 12th & 13th. There will be more late starts on selected weekends over the coming months; as dates are confirmed information will be available via www.luas.ie. Alternative bus transport between the closed stops and Balally Stop will be provided for Luas Customers. Intending passengers should check www.luas.ie for further information.

Sandyford to Cherrywood (Line B1)

BRIDGES

Cherrywood

The construction of the Cherrywood Viaduct will be completed in July. This will clear the way for work to be carried out by SBS (Somague Bowen Sacyr JV), the main infrastructure contractor. Work on laying track and constructing a stop on the viaduct is expected to start later this year. The remaining works in this area will not impact on pedestrian or vehicular traffic.

New Luas Bridge over Brewery Road / Leopardstown Road Roundabout

All of the concrete works on the bridge deck have been completed. The cast in-situ and precast concrete elements of the reinforced earth ramp have also been completed. Upstands for the handrails have been erected and installation of the handrails has commenced and is progressing well. A small section of the site was handed over to SBS on the 30th June to facilitate their works at Burton Hall Road Junction. In the coming weeks Laing O'Rourke will commence alterations to the road and roundabout alignment under the bridge. These works will be carried out at night time with traffic management arrangements similar to those which worked seamlessly for the positioning of the structural steel. Works will be carried out Monday to Friday over a period of about three weeks. It is envisaged that the structure will be substantially complete by mid-August.

New Luas Bridge over M50 at junction 15 (Carrickmines Bridge)

At Carrickmines Bridge the main deck works are complete. Work on both of the reinforced earth ramps is progressing well and the structure will be substantially complete by mid-August.

New Luas Bridge over M50 at junction 14 (Leopardstown Bridge)

Construction of the Luas Bridge over the M50 at Leopardstown continues to progress well with all concrete works for the deck complete. Installation of the aluminium handrails is progressing well as is work on the reinforced earth ramps. It is also envisaged that this structure will be substantially complete by mid-August.

Glenamuck Bridge and road upgrade works

Works are progressing well at Glenamuck Road and Bridge. Two road carriageways and one pedestrian and cycle lane were opened to vehicular traffic at the end of May. We are very pleased to have achieved this on schedule. We would like to thank all concerned for their co-operation during the upgrading works. The remaining works on the bridge are scheduled to be completed by mid-July.

UTILITY DIVERSIONS

Ballyogan Road

On Ballyogan Road, the construction of the new carriageways, cycle-lanes, footpaths and track-bed continues. A speed limit of 30 kph is in place on the temporary surfacing. This speed limit is enforceable by the Gardaí and everybody, including pedestrians, are requested to obey the temporary direction signs.

Traffic was diverted onto the new section of carriageway between Leopardstown Valley and Ballyogan Wood/Ballyogan Vale in the past month. Construction works on the southside of the road have commenced; work will focus initially on providing new water and drainage services and then on carriageway construction. Access to some houses on Ballyogan Road will be affected by these works and we apologise to residents and others for any inconvenience caused.

Work has also started on the re-construction of some garden walls alongside the new Luas track alignment; walls will be raised to 1.8 metres above rail level. We would like to thank those residents affected by these works for their patience and co-operation while the works are being carried out.

LUAS GREEN LINE PARK AND RIDE FACILITIES

Please note that during the Luas works in the Sandyford Park and Ride, alternative pay & display and day rate parking is provided by the local authority in the Sandyford Industrial Estate and Stillorgan Industrial Park.

For more details on the locations and rates check out <http://www.dlrco.ie/roads/payndisplaycharges.pdf>

Please note when you submit your contact details you agree to be added to the RPA Public Consultation Database. To remove your details from the Database simply send us an email to info@rpa.ie. All contact information provided to RPA will be treated as confidential; see www.rpa.ie for details of RPA Privacy Policy.