

# LUAS

## Docklands Line Extension Connolly to The Point (Line C1)

Construction Phase  
Update No.

# 7

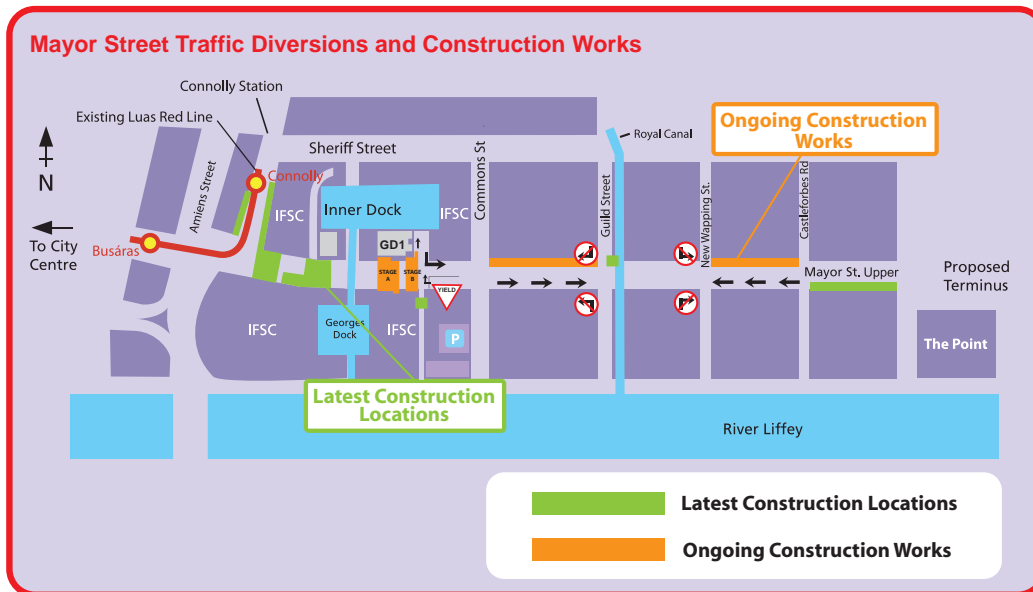

## BRIDGE WORKS

### **George's Dock Bridge Works**

Luas tracks have now been installed on Spencer Dock Bridge and the bridge has been re-opened to pedestrians. Please use the new road layout with caution as the new Luas tracks are now on the bridge. It is important that cyclists cross the tracks as close to a right angle as possible to avoid their bicycle wheel getting caught in the Luas track.

## UTILITY DIVERSIONS

### **MAYOR STREET LOWER**

#### **Between Amiens Street and 2 Harbour Master Place**

We will continue to divert utilities away from the proposed Luas Tram path in the vicinity of 2 Harbour Master Place and in the direction of Connolly Station. Utility connections are required in concentrated areas of the roadway and footway, this will continue over the next week. During these works the traffic will be managed with Stop/Go control with pedestrian routes clearly sign-posted.

#### **Between La Touche House - 1 Harbour Master Place and George's Dock Bridge.**

More underground pipes and cables need to be diverted between La Touche House and George's Dock Bridge on the north and south side of the street. The start date of the diversion is scheduled for week commencing 29th October. Worksites will be undertaken in a phased approach:

- 1 - Starting on the northern side of the street near 1 Harbour Master Place and outside the Harbourmaster Pub and spanning Mayor Street to the southern footway. These works will be ongoing for 3 to 4 weeks
- 2 - Between the middle and end of November, the work site will then move to the middle of the road and simultaneously to the southern side of the road near Munchies, The Laundry and Dry Cleaning shop and O'Brien's for a period of approximately 6 to 8 weeks.
- 3 - Subsequently road works will concentrate on the south side of the road.

The planned work will be on-going until the first quarter of next year. All retailers and shops will remain accessible via diverted routes and are open for business at regular times during these works.

# LUAS

## Docklands Line Extension Connolly to The Point (Line C1)

Construction Phase

Update No.

# 7

### Outside JP Morgan

The works outside the JP Morgan building are still in Stage A (see map). Works have been delayed due to encountering an underground culvert. This has resulted in a re-design of the large manhole in this section and repairs to the roof of the existing culvert. Works in this section will continue until Christmas. We will keep you updated on further progress.

### Outside CHQ building

Works on the footpath in this section have been completed ahead of schedule to allow for the opening of a new department store in the CHQ building over the next few weeks.

### Exchange place

Over the coming weeks, some investigation works are required in the footpath and road surface at the junction of Mayor Street Lower and Exchange Place. During these works the traffic will be managed with a Stop/Go control. Road traffic can get through at all times. Pedestrian routes will be clearly sign-posted.

### Between Commons Street and Guild Street

Works in this section will continue into November. Once this section of works is complete the works site will transfer across on the southern side of Mayor Street Lower. The one-way system will remain in operation, with traffic continuing to flow eastwards along Mayor Street. All retailers and shops remain accessible via diverted routes and are open during the works.

RPA would like to remind vehicle owners to observe signs for disabled parking spaces and loading bays on Mayor Street.

### Guild Street Junction

A new work site will be opened on the eastside of the junction between Mayor Street and Guild Street to allow us to build a manhole in this junction for utilities. These works will take 4 to 6 weeks. The two way traffic flow will be maintained with a Stop/Go system in operation.

### MAYOR STREET UPPER

#### Between New Wapping Street and Castleforbes Road

Works between New Wapping Street and Castleforbes Road will continue into November 2007. The work-sites will be temporarily extended to do some connection works on the junctions of New Wapping Street and Castleforbes Road with Mayor Street Upper.

When the current works are complete the work site will then transfer across to the other side of the street. The one way system will remain in operation with traffic continuing to flow westwards along Mayor Street.

Works have also commenced on the section of Mayor Street Upper which lies directly east of Castleforbes Road. This will not affect the traffic flow.

### OPEN FORUM MEETINGS

RPA Open Forum meetings are held every fortnight in the atrium of the National College of Ireland, Mayor Street from 7:30 am - 9:00am on Thursday mornings. This offers an opportunity for residents and businesses alike to meet RPA personnel. Next Open Forum meetings are on Thursday November 8th and November 22nd.

### LATE NIGHT LUAS 2007

The Late Night Luas service will start on **Friday the 30th of November** and run on Fridays and Saturdays, throughout the week running up to Christmas and **Monday 31st of December**. Last trams will leave both termini at 3.00am on Fridays and Saturdays and every night during the week running up to Christmas. For further details and a full late night and Christmas Luas schedule and fares see [www.luas.ie](http://www.luas.ie).