



**METRO NORTH
ORAL HEARING**

**Sample Composite Drawing for Basement Surveys
1-11 and 45—56 O' Connell Street**



**METRO NORTH
ORAL HEARING**

**Sample Composite Drawings for Basement Surveys for
1-11 and 45—56 O' Connell Street**

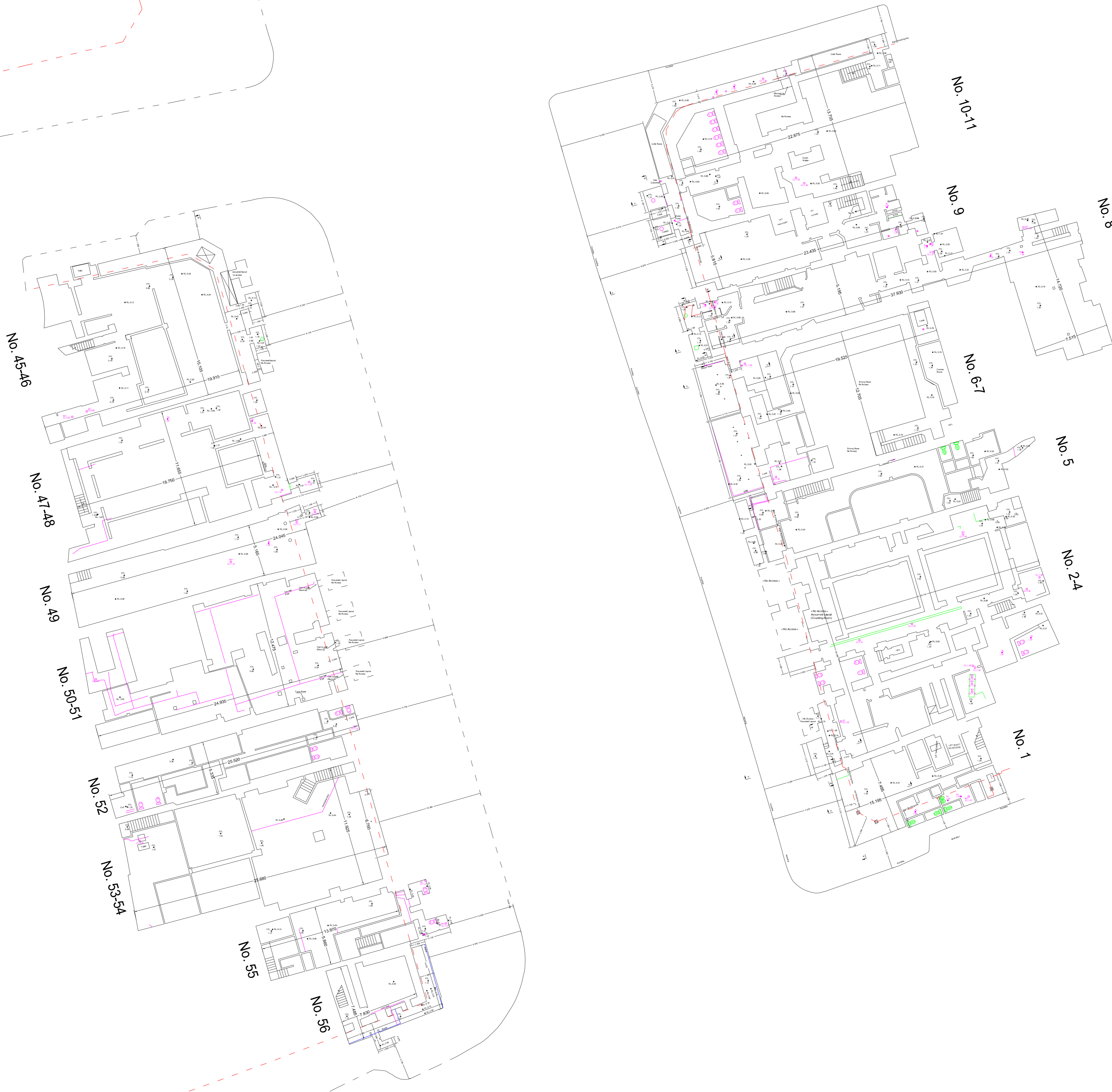
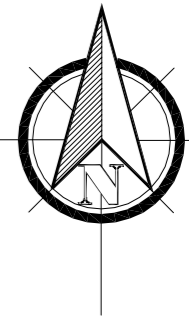

LEGEND

- Direction of Photograph □ 01.7.64
- Gully Trap ○ 01.7.64
- Coal Chute ○ 01.7.64
- Drainage Pipes ○ 01.7.64
- Inspection Chamber □ 01.7.64
- Inspection Chamber □ 01.7.64
- Invert Level IL +7.08
- Finished Floor Level FFL +10.79
- Ceiling Level RL +10.79
- Spot Level 7.85

DRAFT

PAT McGOVERN & ASSOCIATES
CHARTERED BUILDING SURVEYORS

59 Merrion Square, Dublin 2
Tel: 01 6610390
Email: info@patmcgovern.ie
Website: www.patmcgovern.ie



REVISION	DATE	MODIFICATIONS	STATUS	CHECKED

TITLE: MN701 - Basement Surveys		BM
LOCATION: 1-11 & 45-56 O'Connell St. Lower (East & West)		
Drawn By: DOB	Date: 20 March 2009	
Checked By: DOB - Team Leader	Scale: 1:200 (A1)	
Approved By: PMCG	Our Ref: 09C/001/BM	

Railway Procurement Agency
Ghníomhaireacht um Fháil Iamróid
Parkgate Business Centre,
Parkgate Street, Dublin 8, Ireland
Phone +353 1 646 3400
Fax +353 1 646 3401
www.rpa.ie

Responsible for

LUAS METRO

Integrated
Ticketing
System

With funding and
support from

transport21
progress in motion



Railway Procurement Agency
Ghníomhaireacht um Fháil Iamróid
Parkgate Business Centre,
Parkgate Street, Dublin 8, Ireland
Phone +353 1 646 3400
Fax +353 1 646 3401
www.rpa.ie

Responsible for

LUAS METRO

Integrated
Ticketing
System

With funding and
support from

transport21
progress in motion

