

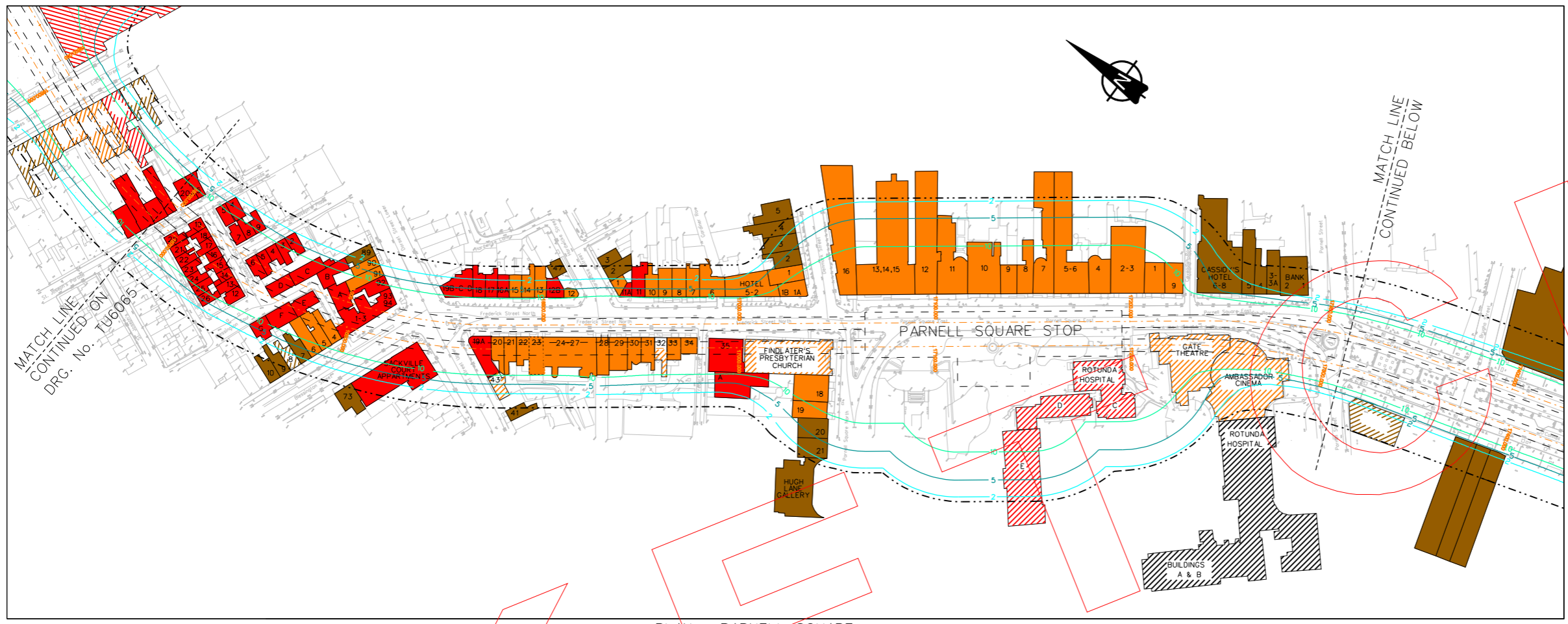

**METRO NORTH
ORAL HEARING**

**Stage 1 Preliminary Ground
Movement Assessment Report
Rev 3_Part19_PartK**



PLAN - PARNELL SQUARE
SCALE 1:1250

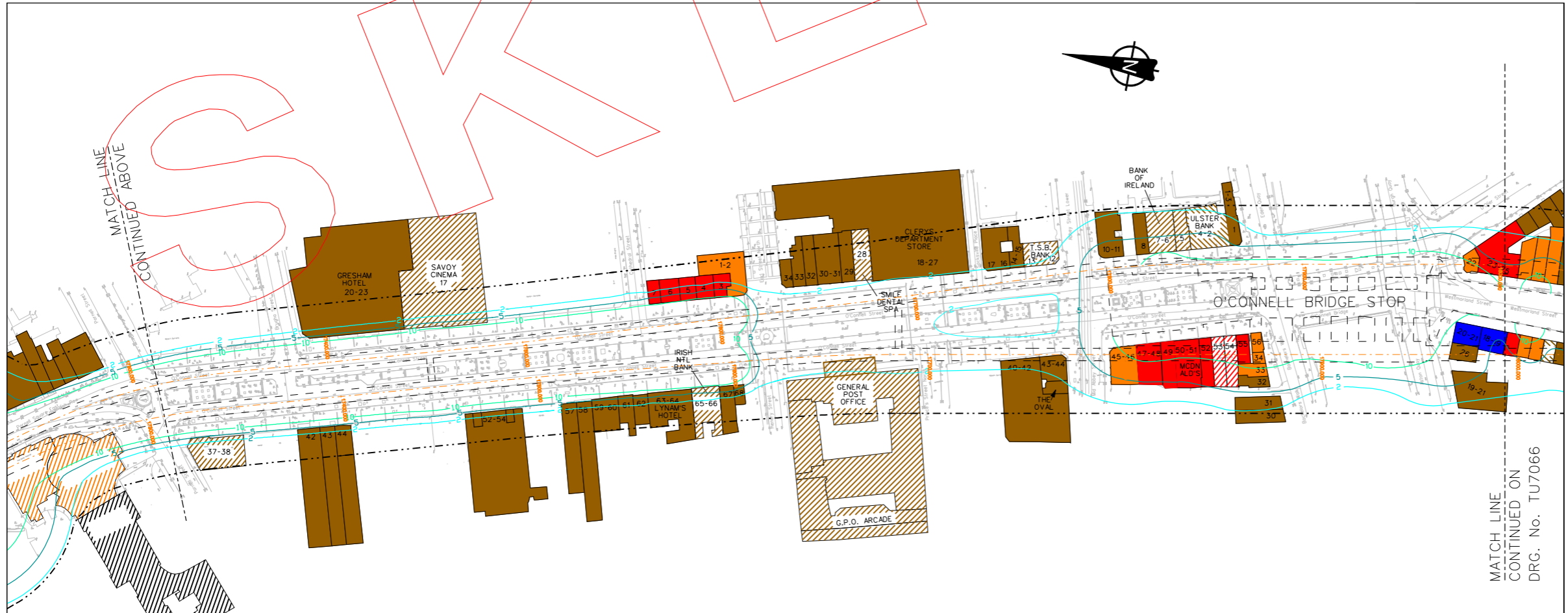

PLAN - O'CONNELL BRIDGE
SCALE 1:1250

SETTLEMENT KEY:		KEY	
5mm CONTOUR	--- 5 ---	NON-SENSITIVE STRUCTURES	NOT PROTECTED IN 10mm ZONE
10mm CONTOUR	--- 10 ---	NOT PROTECTED IN 10mm ZONE	NOT PROTECTED IN 10mm ZONE
		PROTECTED IN 10mm ZONE	PROTECTED IN 10mm ZONE
		PROTECTED OUTSIDE 10mm ZONE	PROTECTED OUTSIDE 10mm ZONE
		NOT PROTECTED OUTSIDE 10mm ZONE	PILED FOUNDATION

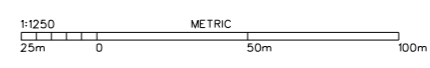

- STANDARD NOTES:**
- DO NOT SCALE FROM THIS DRAWING. USE WRITTEN DIMENSIONS ONLY.
 - DIMENSIONS ARE IN MILLIMETRES UNLESS OTHERWISE STATED.
 - FOR LEGEND REFER TO DRAWING BMN000000001.
 - ALL LEVELS ARE TO MALIN HEAD AS DEFINED BY OSGM02.
 - CHANGES ARE IN METRES RELATIVE TO THE NORTHBOUND TRACK ALIGNMENT UNLESS OTHERWISE STATED.
 - EXTERNAL GROUND LEVELS ARE APPROXIMATE.
- NOTES:**
- THE HORIZONTAL ALIGNMENT SHOWN ON THIS DRAWING IS THE TWIN TRACK ALIGNMENT REVISION ISSUED ON 14 MAY 2008.

SKETCH

- REFERENCE DRAWINGS:**
- BMN0000T07065 SETTLEMENT CONTOURS
 - BMN0000T07065 SETTLEMENT AND BUILDING ASSESSMENT
 - BMN0000T07066 SETTLEMENT AND BUILDING ASSESSMENT

"The information contained herein has been provided by RPA but does not purport to be comprehensive or final. Recipients should not rely on the information. Neither RPA nor any of its directors, officers, employees, agents, stakeholders or advisers make any representation or warranty as to, or accept any liability or responsibility in relation to, the adequacy, accuracy, reasonableness or completeness of the information provided as part of this Document or any matter on which the information is based (including but not limited to loss or damage arising as a result of reliance by recipients on the information or any part of it). Any liabilities are hereby expressly disclaimed."

B04 6 Feb 2009 FINAL ISSUE TO RPA

REV	DATE	DESCRIPTION	BY	CHK	APD

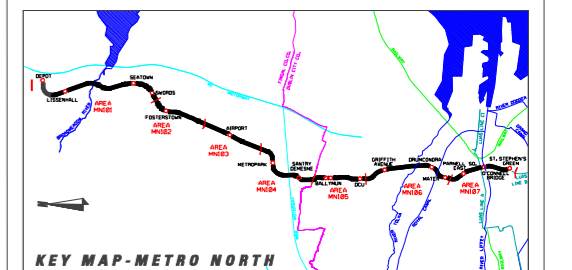

KEY MAP-METRO NORTH

CONTRACT NO.	AREA	CHAINAGE
MN-0000	MN107	

LOCATION
SOUTH OF MATER TO O'CONNELL BRIDGE

DRAWING TITLE
SETTLEMENT AND BUILDING ASSESSMENT

PREPARED BY	DESIGNED BY	APPROVED BY
CHECKED	CHECKED	AS BUILT BY
DATE: 6 Feb 2009	SCALE: 1/1250	SHEET SIZE: A1

STAGE	LINE	CONTRACT	ELEMENT	DRW NO.	DRW REV.
B	MN	0000	TU	7065	B04

© Copyright Railway Procurement Agency.
This drawing is confidential and the copyright in it is owned by the RPA. This drawing must not be either loaned, copied or otherwise reproduced in whole or in part or used for any purpose without the prior permission of the RPA.
All the data used for plans are printed under Ordnance Survey map. G.S. 6017

Railway Procurement Agency
Ghníomhaireacht um Fháil Iamróid
Parkgate Business Centre,
Parkgate Street, Dublin 8, Ireland
Phone +353 1 646 3400
Fax +353 1 646 3401
www.rpa.ie

Responsible for

LUAS METRO

Integrated
Ticketing
System

With funding and
support from

transport21
progress in motion

